

EdenPURE®

Infrared Portable Space Heater with Humidifier

- 1500 Watts with Two Heat Settings
- Automatic Thermostat
- Tip-Over Switch
- Built-In Humidifier
- Room Temperature LED Display
- Precision Temperature Control
- Easy Push-Button Controls
- Remote Control



Model No.: A5827

Owner's Manual

PLEASE READ AND
SAVE THESE INSTRUCTIONS



The EdenPURE® Heater you have just purchased is a safe and powerful heater, designed to fully heat a room after a few minutes of operation. The far-infrared Quartz-PTC heating system is an excellent choice for safely heating whole rooms, while saving on heating costs.

Additionally, this heater includes an overheat protection system, and an inlet air overheat protection system designed to ensure your safety.

This heater does not reduce humidity or oxygen in your home or office, *promoting a healthier environment!*

Before using your EdenPURE® Heater, please take a few minutes to read these instructions, and review the product's limited warranty.

Thank you!

WARNING! To reduce the risk of fire, electric shock, or personal injury, read all the instructions before using this heater. This appliance is intended for household or personal use only as described in this manual. Any other use including but not limited to commercial, agricultural, or outdoor use, is not recommended by the manufacturer and may cause fire, electric shock, injury and/or damages. The use of any attachments and accessories or extension cords are not recommended, and may cause hazards and void the warranty.

IMPORTANT INSTRUCTIONS

When using this appliance, basic precautions should always be followed to reduce the risk of fire, electric shock and injury to persons, including the following.

1. Read all the instructions before using this heater.
2. This heater is hot when in use. To avoid burns, do not let bare skin touch hot surfaces. Keep combustible materials, such as furniture, pillows, bedding, papers, clothes and curtains at least 3 feet (0.9 m) from the front of the heater and away from the sides and rear.
3. Extreme caution is necessary when any heater is used by or near children or persons with physical challenges and whenever the heater is left operating and unattended.
4. Do not operate the heater with a damaged cord or plug, or if the heater malfunctions, has been dropped, or is damaged in any manner. Return the heater to an authorized service facility for examination, electrical or mechanical adjustment, or repair.
5. Do not use outdoors.
6. This heater is not intended for use in bathrooms, laundry areas or similar indoor locations. Never locate the unit where it may fall into a bathtub or other water.

container.

Never yank on the cord.

7. Do not run the cord under carpeting and do not cover the cord with throw rugs, runners or the like. Do not route cord under furniture or appliances. Arrange the cord away from traffic areas to avoid a tripping hazard.
8. To disconnect the heater, turn controls to OFF, then remove the plug from outlet.
9. Do not insert or allow foreign objects to enter any ventilation or exhaust opening as this may cause an electric shock, fire or damage to the heater.
10. Connect to properly grounded outlets only.
11. To prevent a possible fire, do not block air intakes or exhaust openings in any manner. Do not use on soft surfaces, like a bed, where openings may become blocked. Use the heater on flat, dry surfaces only.
12. A heater has hot and arcing or sparking parts inside. Do not use the heater in areas where gasoline, paint or flammable liquids are used or stored.
13. Use this heater only as described in this manual. Any other use not recommended by the manufacturer may cause fire, electric shock or injury to persons.
14. **Never** clean this heater while it is plugged in. Do not immerse in water. To disconnect, turn control to OFF, then remove the plug from the outlet by grasping it and pulling it from the outlet.
15. This heater includes a visual alarm to warn that parts of the heater are getting excessively hot. If the alarm flashes, immediately turn the heater OFF and inspect for any objects on or adjacent to the heater that may cause high temperatures. **DO NOT OPERATE THE HEATER WITH THE ALARM FLASHING.** To reset the heater, turn it OFF, unplug it from the electrical outlet, and wait five to ten minutes for the unit to cool down before plugging it back in and turning the heater on.
16. Always unplug the heater when it is not in use.
17. Always plug heater directly into a wall outlet/receptacle. Never use with an extension cord or relocatable power tap (outlet/power strip).
18. It is normal for the heater's plug and cord to feel warm to the touch. A plug or cord which becomes hot to the touch or becomes distorted in shape may be a result of a worn electrical outlet. Worn outlets or receptacles should be replaced prior to further use of the heater. Plugging this heater into a worn outlet may result in overheating of the power cord or fire.
19. Make sure the plug is fully inserted into an appropriate receptacle. Be mindful that receptacles also deteriorate due to aging and continuous use. Check periodically for signs of overheating or deformations of the plug. If any overheating or

deformation occurs, immediately discontinue using the heater and contact an EdenPURE® Heater Authorized Service Center.

20. **CHECK YOUR HEATER CORD AND PLUG CONNECTIONS.**

Faulty wall outlet connections or loose plugs can cause the outlets or plug to overheat. During use, please check frequently to determine if your plug outlet or faceplate is HOT! If it is hot, discontinue using the heater and/or make certain a qualified electrician checks and replaces the faulty outlet(s).

CAUTION: This appliance is not intended for use by persons (including children) with reduced physical, sensory or mental capabilities, or lack of experience and knowledge, unless they have been given supervision or instruction concerning use of the appliance by a person responsible for their safety.

SAVE THESE INSTRUCTIONS

Humidifier Attachment

Installation:

1. Open the humidifier packing and remove the humidifier attachment, as shown in Figure 1.

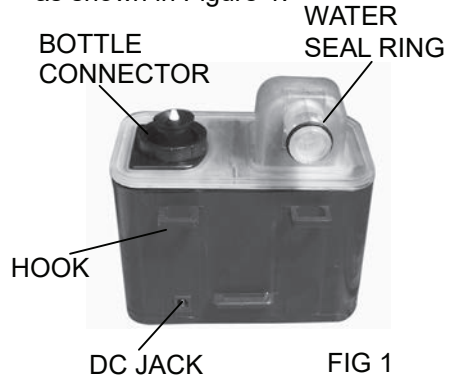

2. Take out the water bottle (Max. 500 ml.) from the package and fill the water bottle with distilled water. Then fully tighten the connector on the water bottle as shown in FIG 2.



FIG 2

CAUTION: You must use distilled water to keep the humidifier working properly. Also, make sure the connector is tightened to the bottle to prevent water leakage.

3. Fully insert the humidifier into the two hooks located in the rear side of the wooden box as shown in Figure 3.

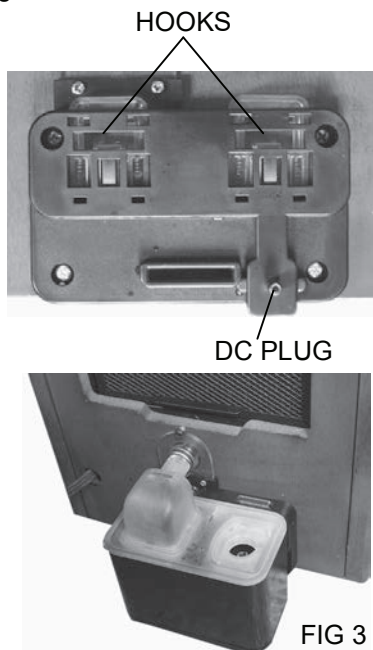

CAUTION: Make sure the two hooks are fully inserted and the DC PLUG is connected to the DC JACK.

4. Push down the moisture outlet cover on top of the wooden box as shown in Figure 4.



CAUTION: Make sure the moisture outlet cover is pushed down before using the humidifier attachment.

5. Insert bottle, attached to connector, into the humidifier, as shown in Figure 5.



Operating Instructions

1. Plug the power supply cord into a grounded wall outlet. (120V, 60Hz).

Important: This heater comes with a grounded (three-prong) plug. The grounded plug must be used with a grounded outlet. Do not use an adapter in a two-slot wall outlet unless the ground plug of the adapter properly connects to a building ground. Using the heater without a properly grounded outlet or adapter could result in an electric shock hazard.

2. TURNING THE HEATER ON

To turn the heater ON, press the POWER button; the power LED will turn on. Next, press the MODE button; the heat setting will be set to ECO. Press the MODE button again to set to HIGH. Press the button a third time to set to LOW. Press the button a fourth time to turn the heater OFF.

3. TURNING THE HEATER TO STANDBY OFF

To turn the heater to Standby OFF, press the Standby OFF button. The heater will shut off but the fan will continue to run until all the heat has been expelled. The heater will turn off automatically and is set to Standby mode. If you are not going to use the heater for a long time, press the POWER button to fully shut down the heater. The power LED will turn off.

4. SETTING THE THERMOSTAT

Press the MODE button, and set to ECO mode to engage the automatic thermostat.

5. SETTING THE TEMPERATURE

To set the desired temperature:

Press the ▲ button once until the numeric temperature starts flashing.

Press the ▲ button again to increase the temperature or the ▼ button to decrease the temperature.

After the desired temperature is set, this will be your ideal setting. The heater will run on HIGH until the

room temperature reaches the set temperature. The heater will then switch to run on LOW for 10 minutes. The heater will turn off if the room temperature is equal to or greater than the set temperature. (The fan will continue to run a minute until all of the residual heat has been expelled).

For example: If your ideal setting is 72°F, the heater will run on HIGH until it reaches 72°F. The heater then will switch to run on LOW for 10 minutes. The unit will turn off if the room temperature is equal to or greater than the set temperature.

The default temperature setting is preset from the factory at 68°F.

Remote Control

HOW TO INSERT BATTERIES

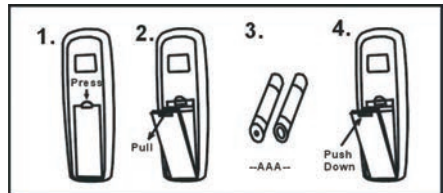

NOTE: Remove the batteries if the remote control is not to be used for a month or more. Batteries left in the unit may leak and cause damage.

DO NOT MIX OLD AND NEW BATTERIES! DO NOT MIX ALKALINE, STANDARD (CARBON-ZINC) OR RECHARGEABLE (NICKEL-CADMIUM) BATTERIES!

Instructions for the Use of the IR Remote Control

The buttons of the remote control function in the same manner as those on the control panel on the front of the heater. Set the timer by using the remote control.

Setting the Timer

1. Press the TIMER button until Set Time starts flashing. The default value is 3 hours.
2. Press the “+” button to increase the set time or the “-” button to decrease the set time.
The timer can be set from 1 to 12 hours. The timer will set and execute after the LED display stops flashing. The heater will shut OFF automatically when the set time is reached.
3. To turn the timer OFF, follow step 1, pressing the “-” button to set the time to 0. The timer feature will turn off when the LED stops flashing.

Maintenance

1. Always turn OFF the heater and disconnect the cord from the electrical outlet **before** cleaning the unit.
2. Light accumulation of dust may be removed from the heater with a soft cloth or vacuum cleaner.

3. Wipe the exterior surfaces of the heater occasionally with a damp cloth (not dripping wet), using a solution of mild detergent and water. Dry the case thoroughly before operating the heater.

Caution! Do not allow water to run into the interior of the heater as this could create a fire or electric shock hazard.

4. The fan motor is factory-lubricated for life and will require no further lubrication.
5. Store the heater in a clean, dry place when it is not in use.

Cleaning the electrostatic filter

The heater has an electrostatic filter located at the rear. The cleaning of the filter should be performed once per month or as needed (when dust is visible on the filter) to ensure efficient operation of the heater.

1. Power the heater OFF by pressing the POWER button located on the left side of the Control Panel.
2. Unplug the heater’s power cord.
3. Release the filter by pushing the filter up from below (Figure 1).
4. Remove the filter by pulling down and out (Figure 2).
5. Clean the filter by vacuuming.
6. Replace the filter by sliding the top upwards into the spring loaded slot on the back of the heater (Figure 2). Then gently push the bottom of the filter into place (Figure 1).



Figure 1



Figure 2

Warning: Any other servicing needed must be performed by an authorized service representative. Do not attempt to service the unit yourself.

Product Specifications

Model No.: A5827

Voltage: 120V, 60Hz

Current: Maximum continuous draw:
12.5 amps

Output: 5200 BTUs

Power: 1500 Watts

Turbo Fan: Multi-blade; Low Noise

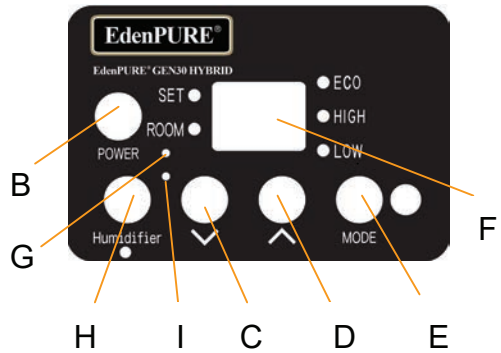
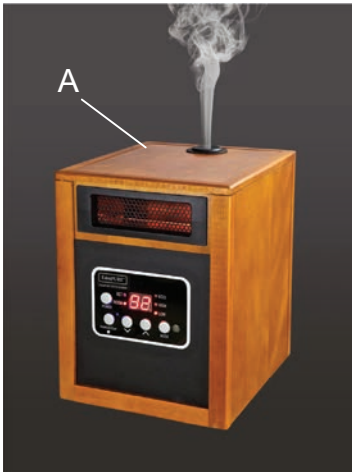

Features

- | | |
|---------------------------------------|-----------------------------------|
| A. “Cool-To-Touch” cabinet | F. LED temperature display |
| B. POWER button | G. Visual alarm LED |
| C. Decrease temperature button | H. Humidifier button |
| D. Increase temperature button | I. Humidifier LED |
| E. MODE button | |

Special Features

LED Display – When the unit is plugged in, the LED display will show the room temperature. At ECO mode, it will display the set value for 2 minutes after the desired temperature is set.

Overheat Shut-Off Protection System –This heater includes a protection system that shuts off the unit if it overheats for any reason.

Inlet Air Overheat Protection System – This heater will automatically shut off if the inlet air duct becomes obstructed and causes the unit to overheat.

Safety Tip-Over Switch – The EdenPURE® Heater is designed to shut off automatically when tipped in any direction. Place the heater on a flat, smooth, stable surface to prevent the heater from tipping over again. When returned to a normal upright position, the heater is ready for use again. This is a safety feature to avoid the possibility of fire should the unit be tipped accidentally.

Note: There may be a trace of smoke or odor when the unit is first operated. Do not be alarmed. This indicates a drop of oil fell on the interior coils during the manufacturing process. It will quickly evaporate and should not recur.

QUESTIONS AND ANSWERS

If the heater cycles ON/OFF without heating:

*Please note: This is a **smart heater** that monitors the room temperature and produces heat only when needed.*

You can set the desired room temperature with the heater in either ECO HIGH or ECO LOW mode. (The factory default setting is 68°F.) For an example of how the heater works, let's say you set the temperature for 70°F. Once the room has reached 70°F, the heater switches off and the fan stops (Note: The heater remains on STANDBY as long as you do not POWER OFF). As the heater remains on STANDBY, it will read the room temperature every 5 minutes by running the fan ONLY for 30 seconds. During this process, the fan also blows out the residual heat from inside the chamber to ensure an accurate temperature reading of the room. If the room temperature is at 70°F (or higher), the heater will remain on STANDBY. It will repeat this *sensing cycle*, reading the room temperature, every 5 minutes. However, if the room temperature drops 2 degrees *lower* than the set temperature, the heating function will turn the heater ON and the fan will blow warm air.

If the heater cycles but doesn't produce heat for hours:

If the temperature is set *lower* than room temperature, the heater will perform *only the sensing cycle* and the heater will not turn on in the heating function. To have the heater turn on, *always* set the desired temperature *higher* (2°+) than the room temperature, or manually select High or Low to have instant heat.

How to turn off the heater:

Switch to STANDBY mode or POWER OFF the heater.

Does the blower cycle use much electricity?

The blower fan will run for 30 seconds every 5 minutes to clear residual heat inside the chamber, while at the same time measuring the room temperature. This uses *less than 18 watts* of power to operate.

Why does the blower fan keep running after I have pressed the power OFF button?

The blower fan will continue to run until the heat chambers cool down. After a few minutes the fan will shut off automatically.

What if the heater's airflow seems to have diminished?

Please ensure the rear intake is not blocked and that the filter is clean. Please follow the filter maintenance procedure to clean the filter.

Once the heater is turned on, how long will it take to heat my room?

This heater can heat up to 1,000 square feet. Generally speaking, it takes minutes to heat a room. Remember that with any type of heating process, there are many variables such as the size of the room, how well the room is insulated, how many doors and windows there are, the amount of bare concrete (which acts as a heat sink with any type of heating), the opening and closing of an exterior door, the outside temperature, etc. Please remember that this is a zone heater and is meant to be used as a *supplemental* heating source only.

Can I use the heater to heat multiple rooms at the same time?

Keep in mind that heating will vary based on how open your floor plan is and the size of the rooms involved. We have heard from customers that with the help of ceiling fans, they have been able to heat multiple rooms simultaneously by placing the unit in a central room. We suggest you give it

a try and see what works best for you.

My home is not well insulated; will this heater help me?

Yes, but it may take a little longer to heat the room. The outside temperature will also have an impact on heating time. Once the room has reached the desired temperature, it will cycle on and off accordingly.

Can the heater be used in a bathroom?

It is not recommended due to a bathroom's high level of moisture.

Can the heater be used in a basement or garage?

Yes, but keep in mind that rooms with little insulation will not retain the heat as efficiently. Bare concrete floors, which act as a heat sink with any type of heating, will absorb some of the heat. However, placing the heater a few feet above the floor will allow for more efficient heating.

Can I use more than one heater at a time?

Yes, but please make sure the heaters are not on the same circuit. Each heater and appliance should be on its own circuit.

Can I use the heater and another appliance at the same time?

Yes, as long as they are not on the same circuit. This heater is considered to be an appliance. You should not run more than one large appliance on a single circuit breaker. Your appliances, such as a freezer, refrigerator, microwave oven, washing machine, dryer and others, should not share a circuit breaker.

Can I use the heater on a job or construction site?

This heater is not designed to be used in a high dust construction environment. Using the heater for this purpose will void your warranty.

Can I move the heater around while it is operating?

It is not recommended to move any portable heater while it is operating. We recommend moving the heater only once the fan has completely turned off.

What is the life expectancy for the heater?

This heater uses one infrared tube (which is rated for 20,000 hours and up), and one PTC element (which is rated for 80,000 hours and up).

What is zone heating?

Zone heating focuses heat where people spend the most time. After all, there is no point in heating multiple rooms to +68 degrees when not in use.

Can I use an extension cord, surge protector, or power strip with my heater?

No. The EdenPURE® Heater is designed to plug directly into a grounded 120V 15 Amp or higher circuit receptacle. Never use with an extension cord or relocatable power tap (outlet/power strip).

How many kilowatts per hour does the heater use?

The EdenPURE® Heater GEN30 uses approximately 1.26 kilowatts per hour.

What is the BTU Rating for the heater?

The EdenPURE® Heater GEN30 produces approximately 5200 BTUs.

The power cord feels warm to the touch; should I be concerned?

It is normal for the heater's plug and cord to feel warm to the touch. A plug or cord which becomes hot to the touch or becomes distorted in shape may be a result of a worn electrical outlet. Worn outlets or receptacles should be replaced prior to further use of the heater. Plugging this heater into a worn outlet may result in overheating of the power cord or even a fire.

I don't have a grounded outlet; can I use a cord adapter or remove the grounding plug?

NO. If you don't have a grounded outlet, contact a licensed electrician in your area for advice. Removing or altering any part of the heater is unsafe and will also void your warranty.

How long is the warranty?

This heater comes with a ONE-YEAR LIMITED COMPONENT WARRANTY. If your unit does not appear to be working properly, please contact our service center by calling 1-800-225-6595. Prior to your call, we encourage you to visit our service related website www.edenpuresupport.com for troubleshooting tips and service instructions if needed.

EdenPURE®

7800 Whipple Ave. NW

N. Canton, OH 44720

800-225-6595

www.edenpureservice.com

©2020 EdenPURE® I-5672 BR12025R-1